

TUTORIAL DIALUX

1. Buka aplikasi dialux

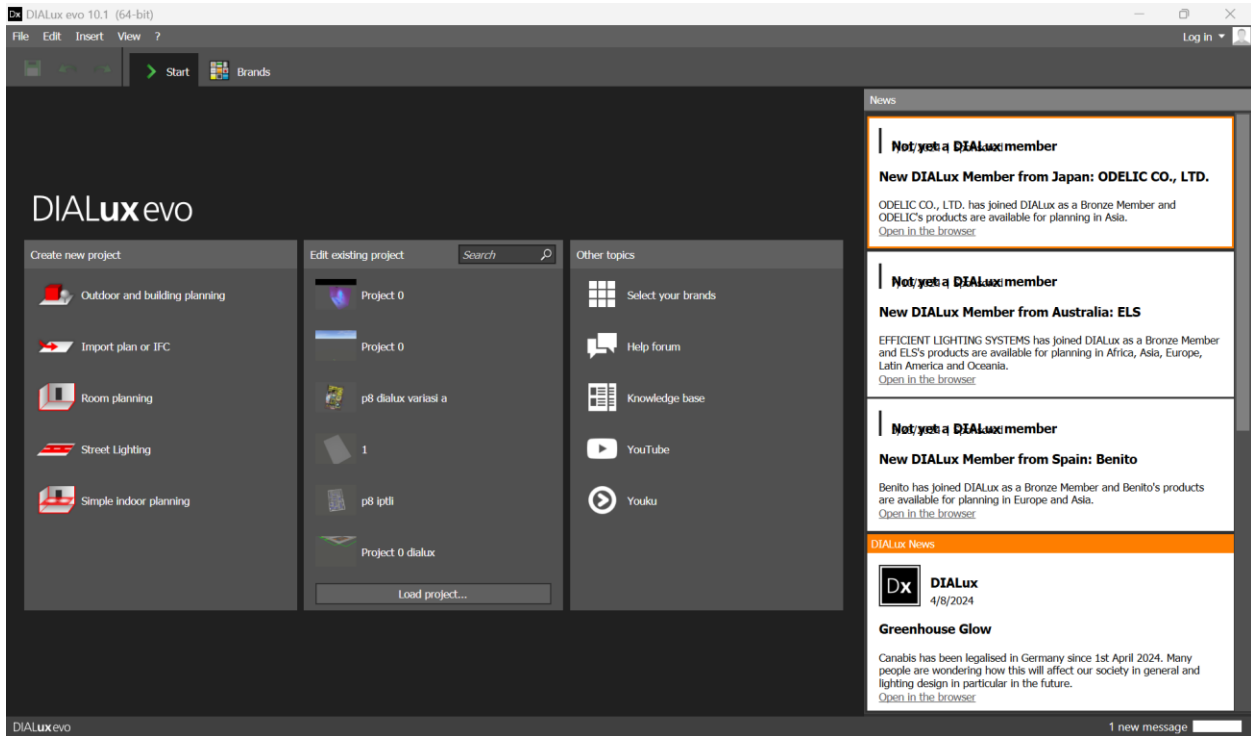

2. File → New project

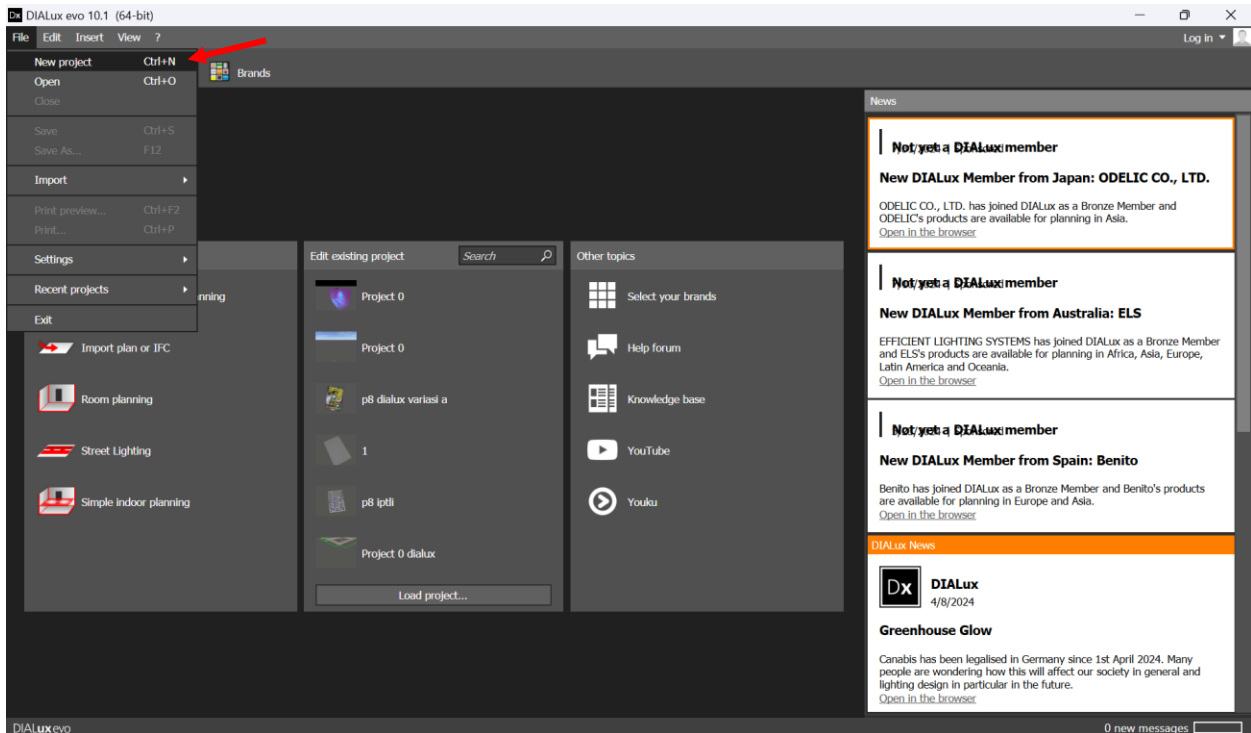

3. Import file dwg

- Plans → Load plan → pilih file yang ingin ditampilkan

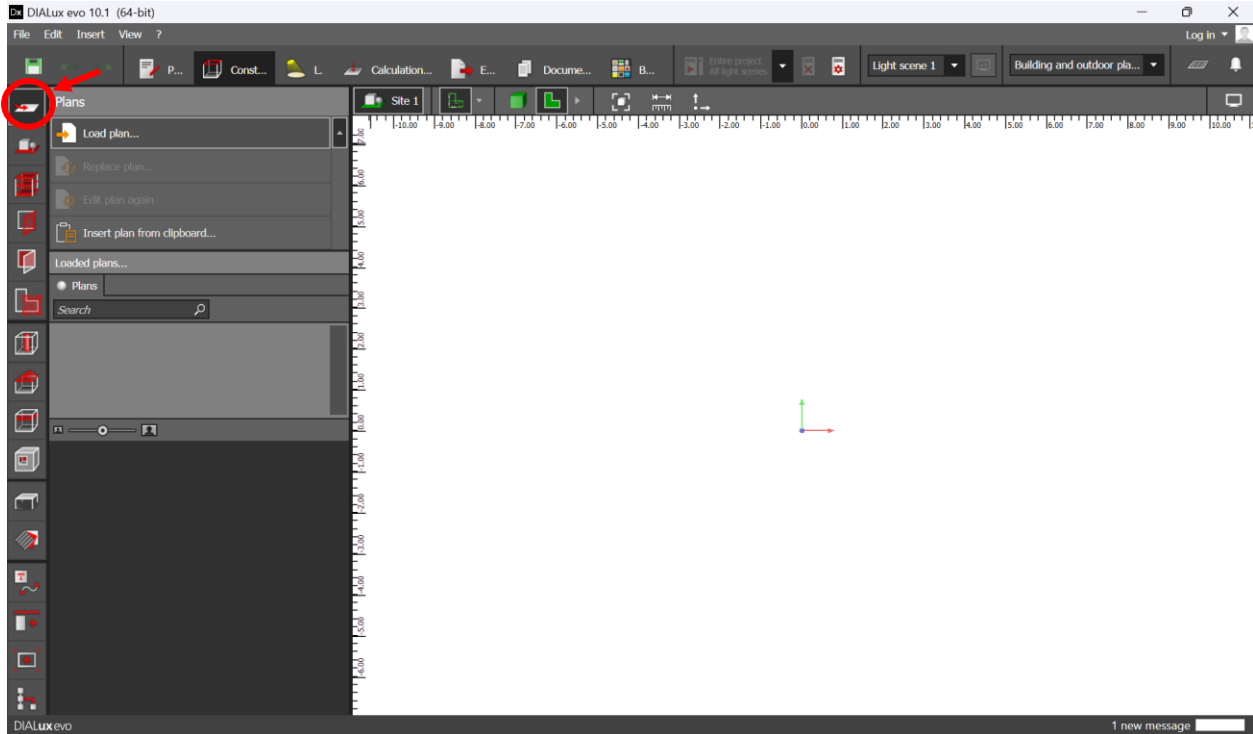

- Tampilan file dwg pada dialux, kemudian klik next

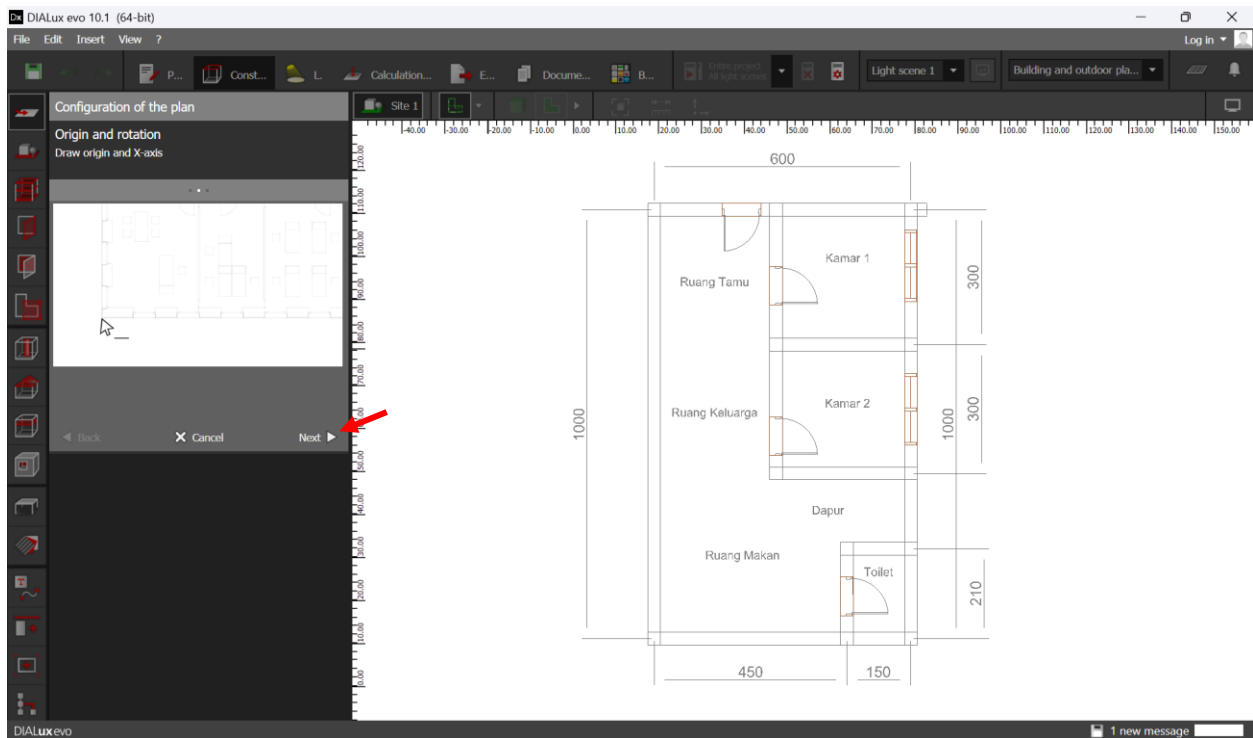

- **Pilih unit ke centimeter**

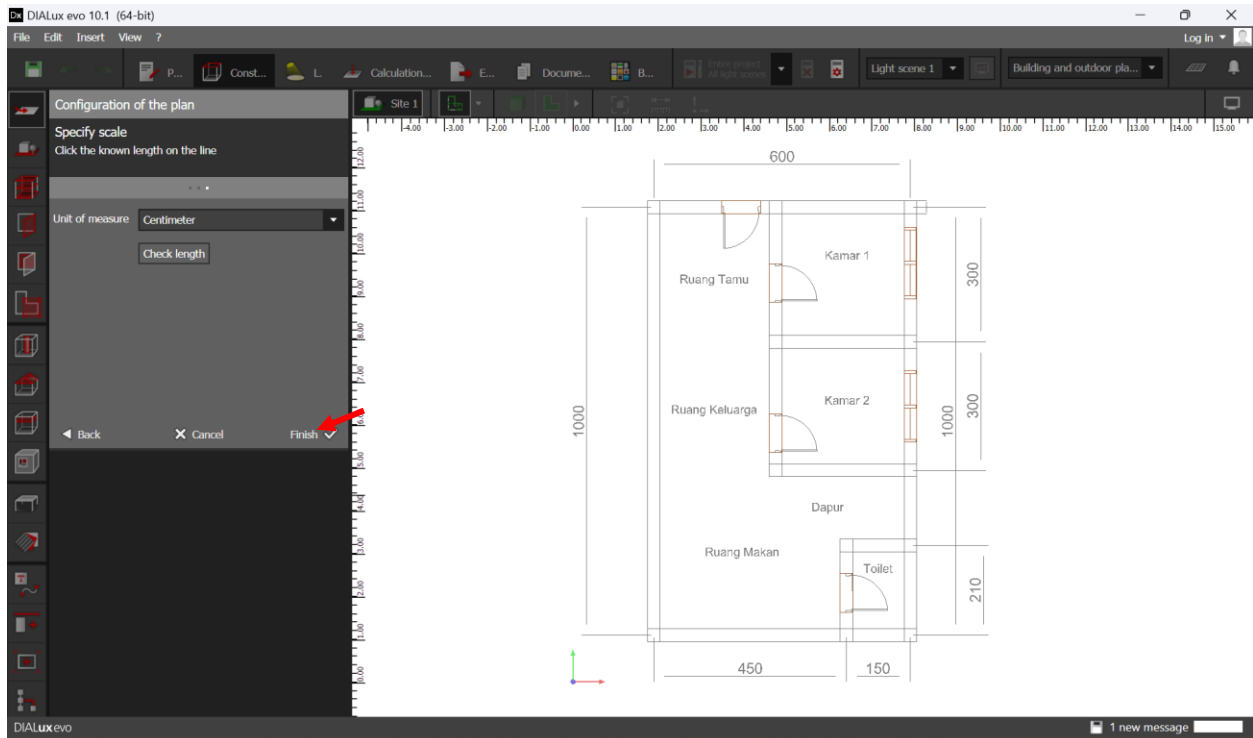
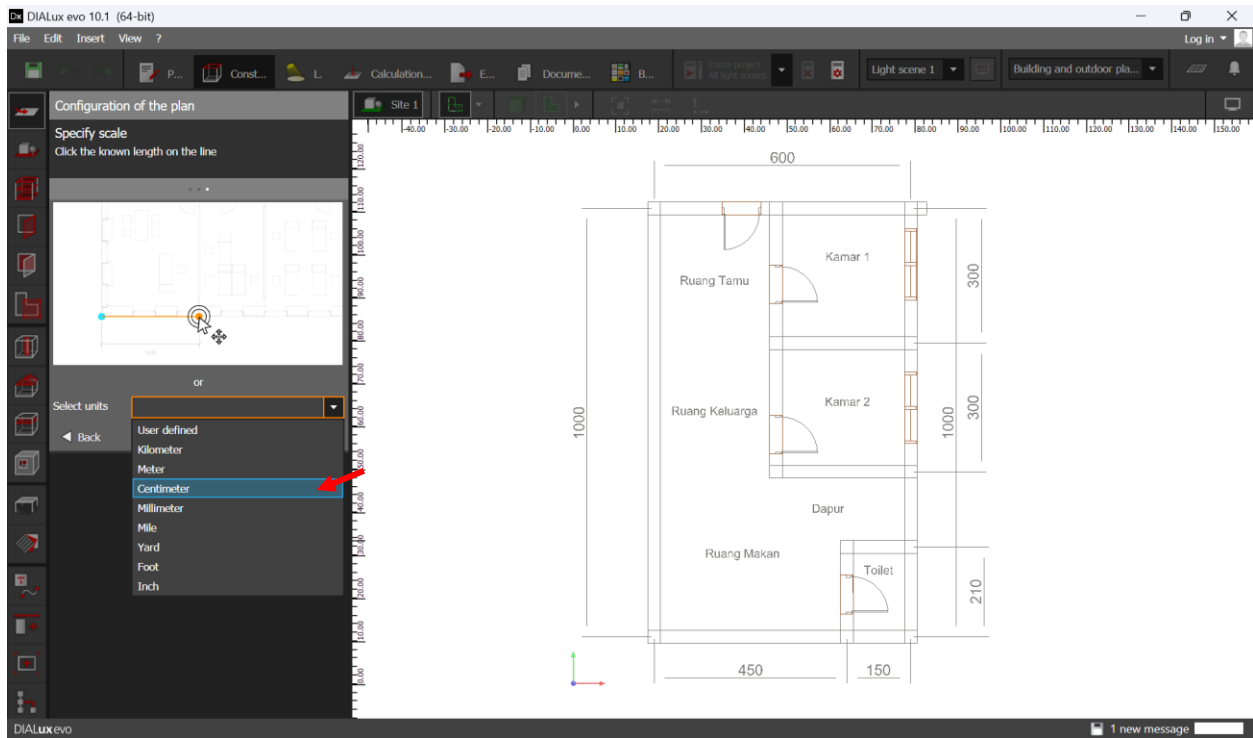

4. Membuat lantai

- **Klik Draw rectangle floor elements**

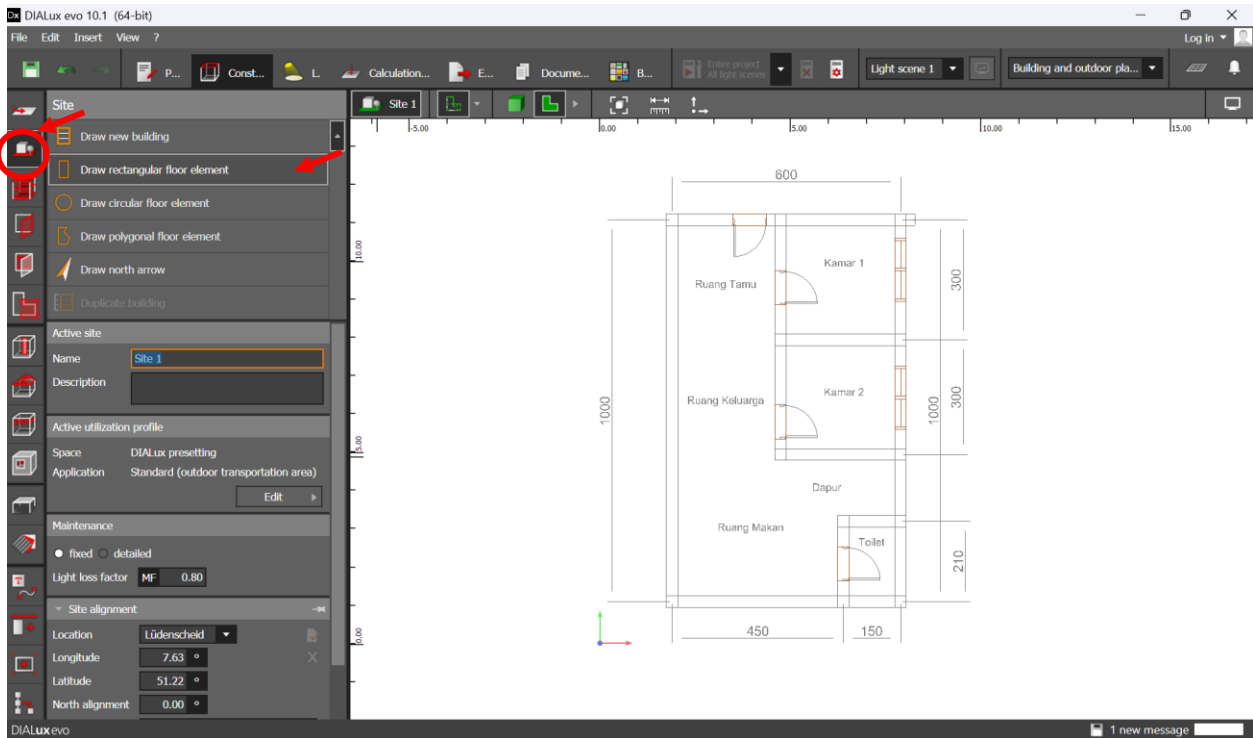

- Drag kursor ke sketsa

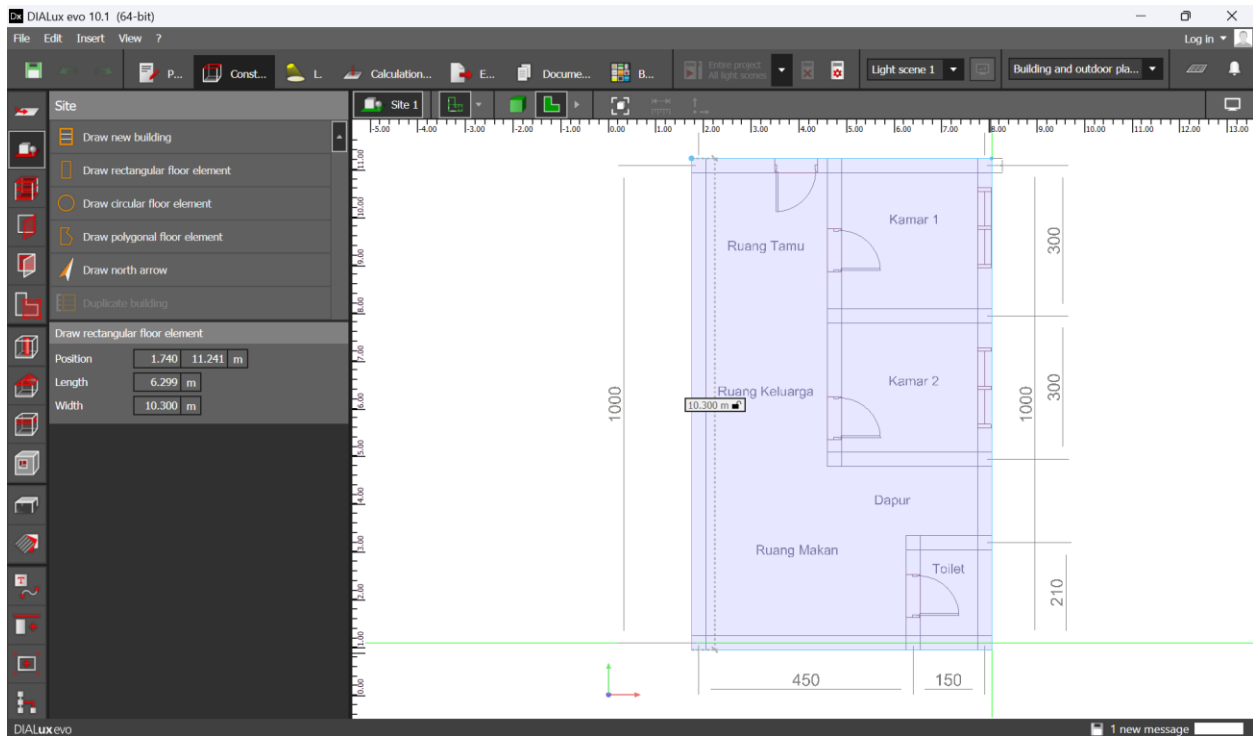

Untuk menampilkan 3D

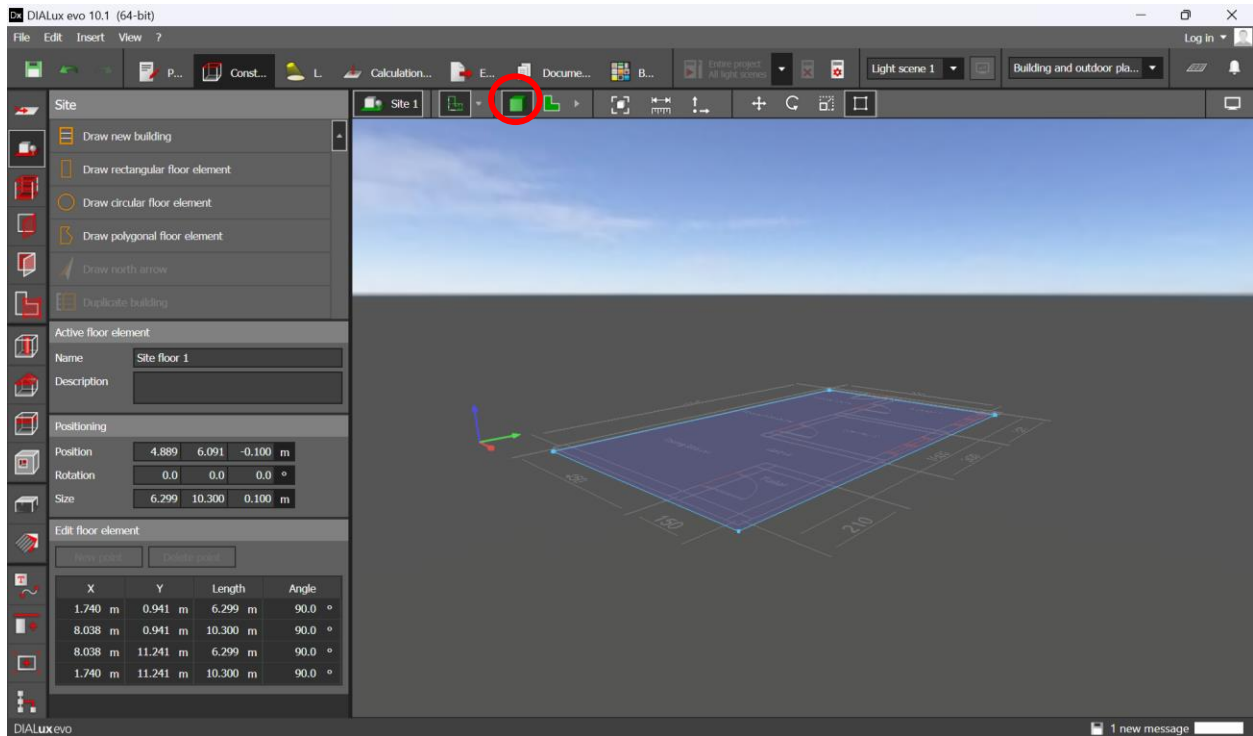

5. Membuat tembok bangunan

Klik draw new building

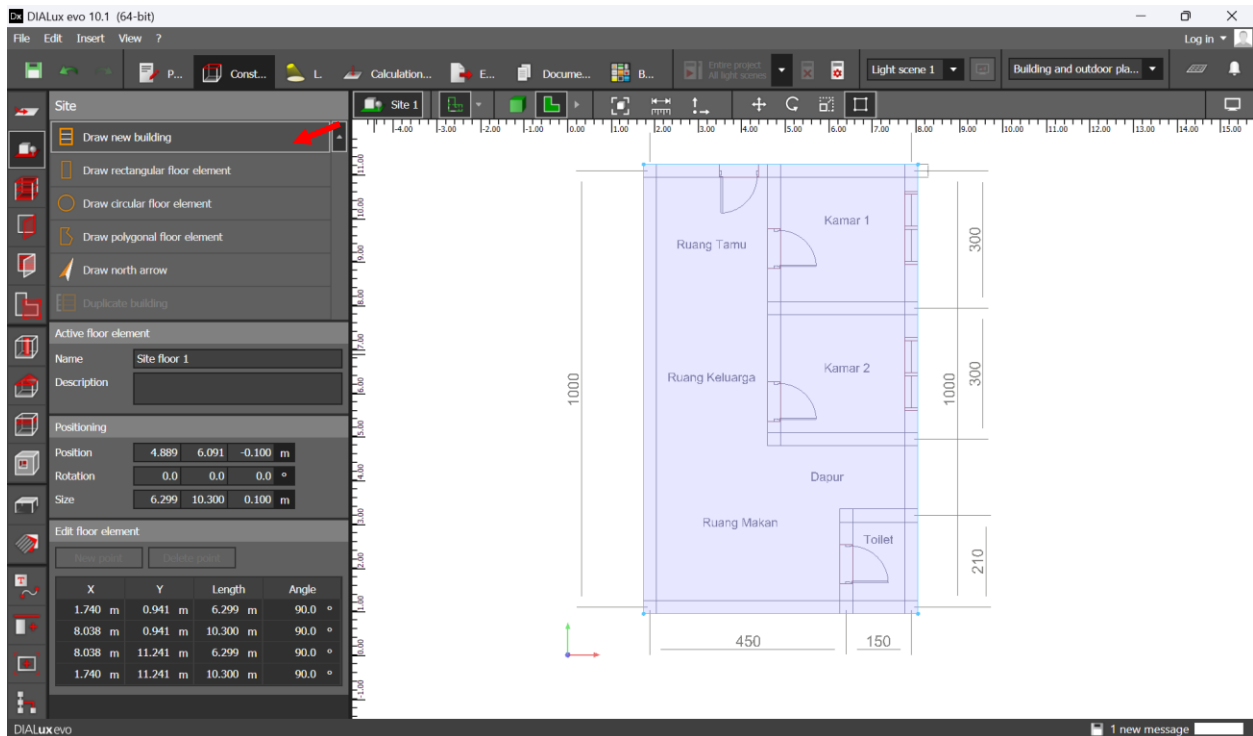

Isi tinggi bangunan 3.5 meter

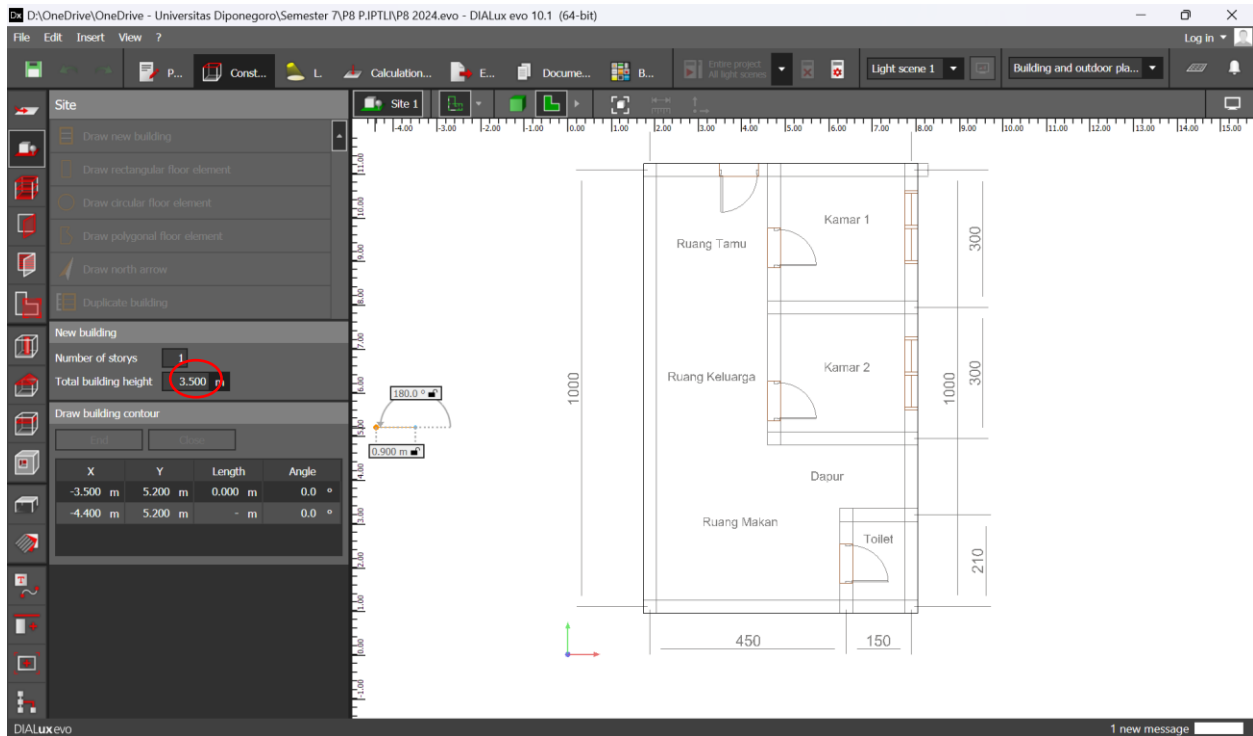

Sorot pada titik bagian luar

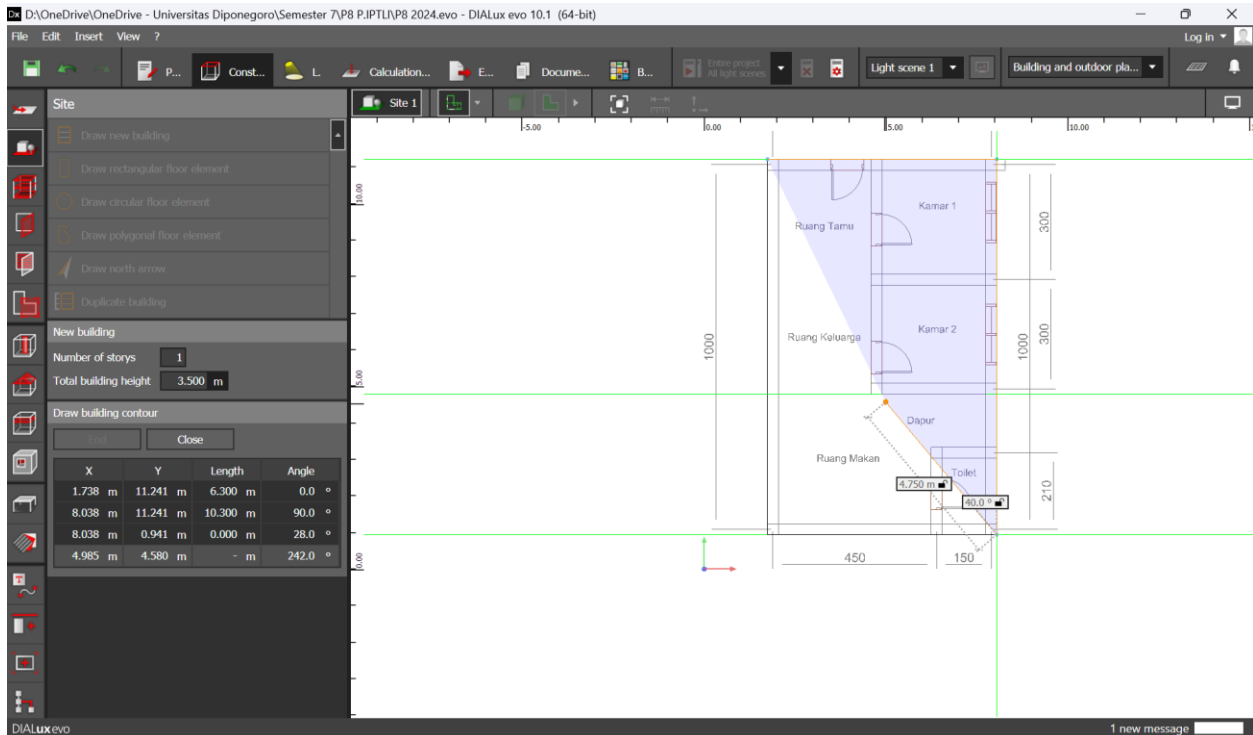

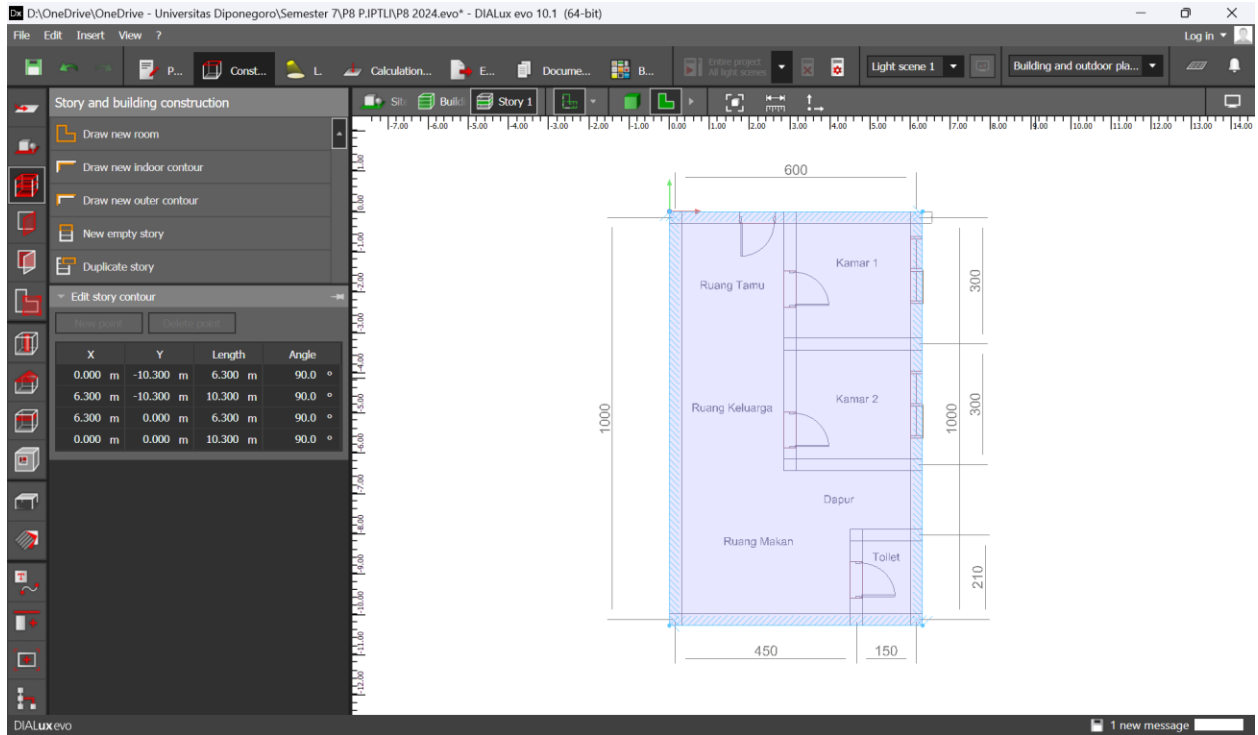

Klik kanan untuk close poligon

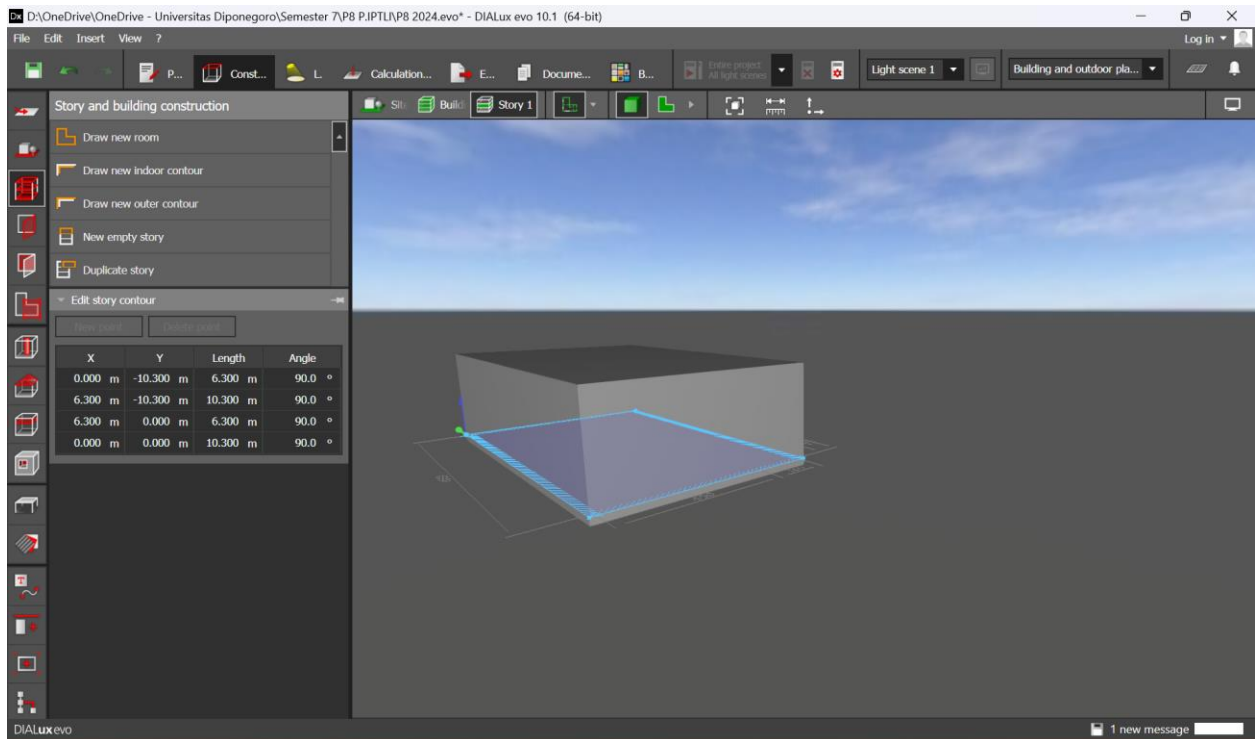

6. Buat ruangan

Klik Draw new room → sorot pada titik bagian dalam

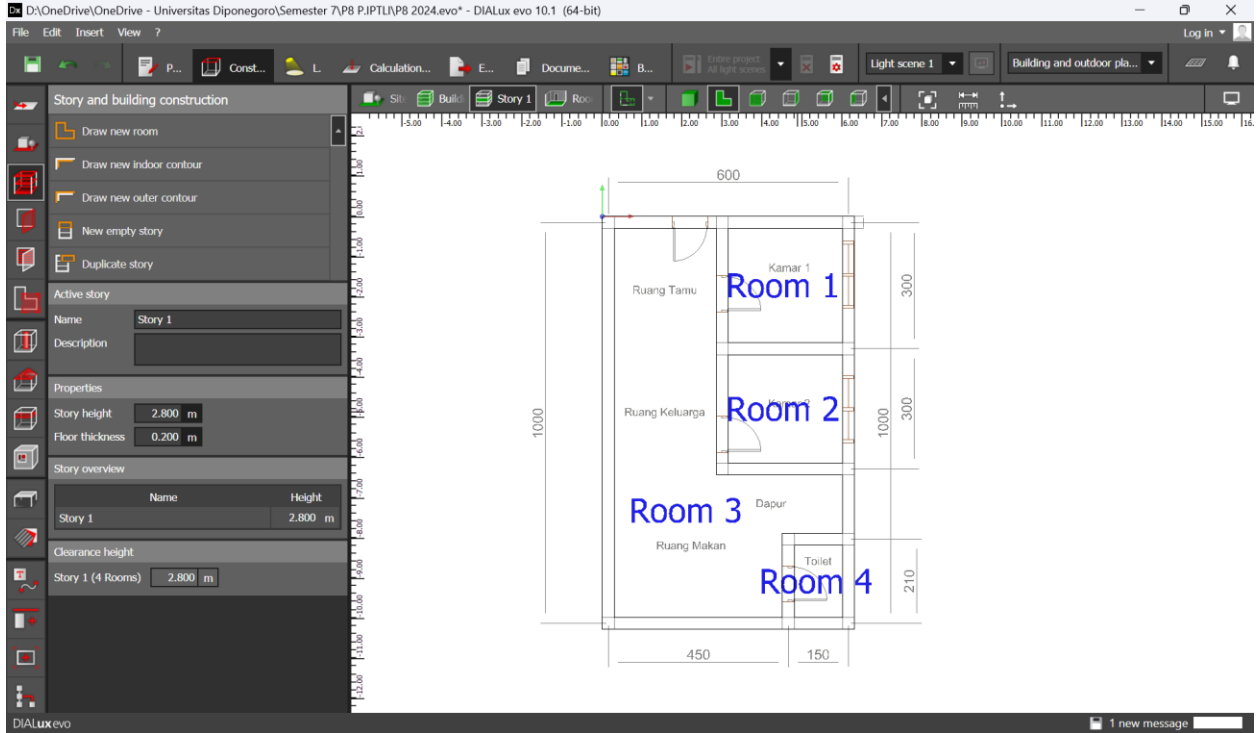
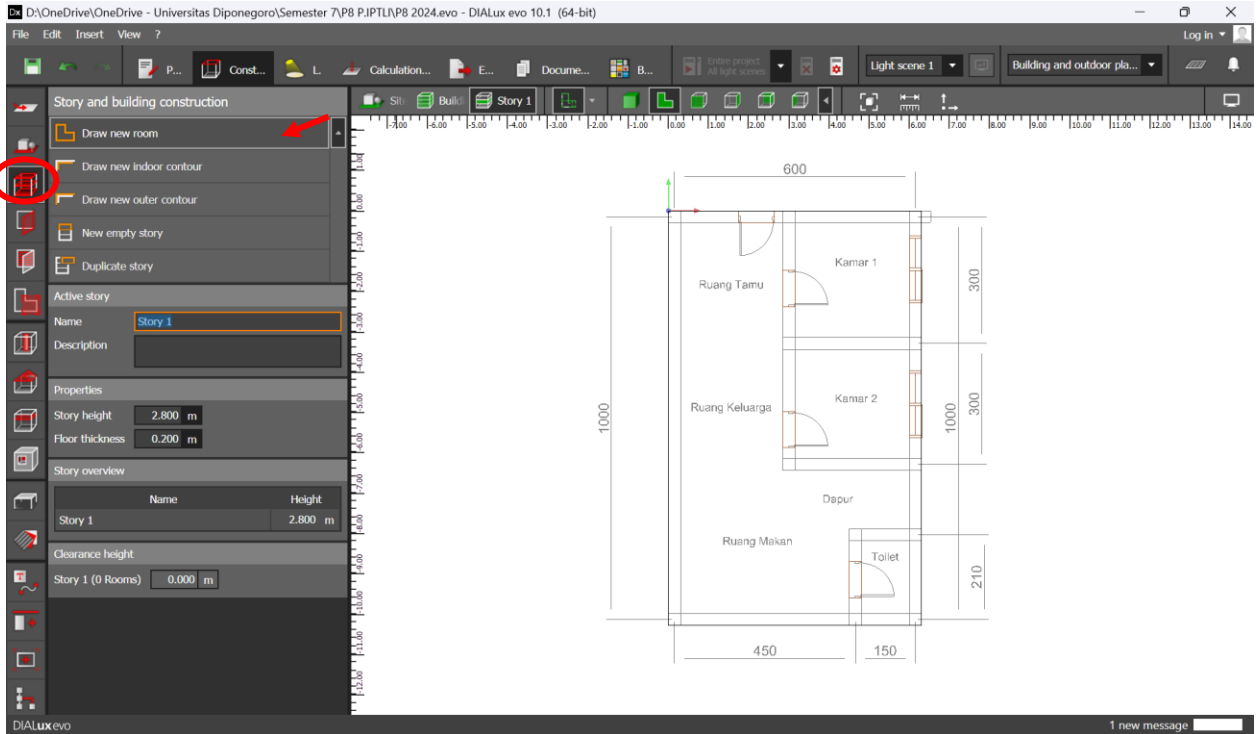

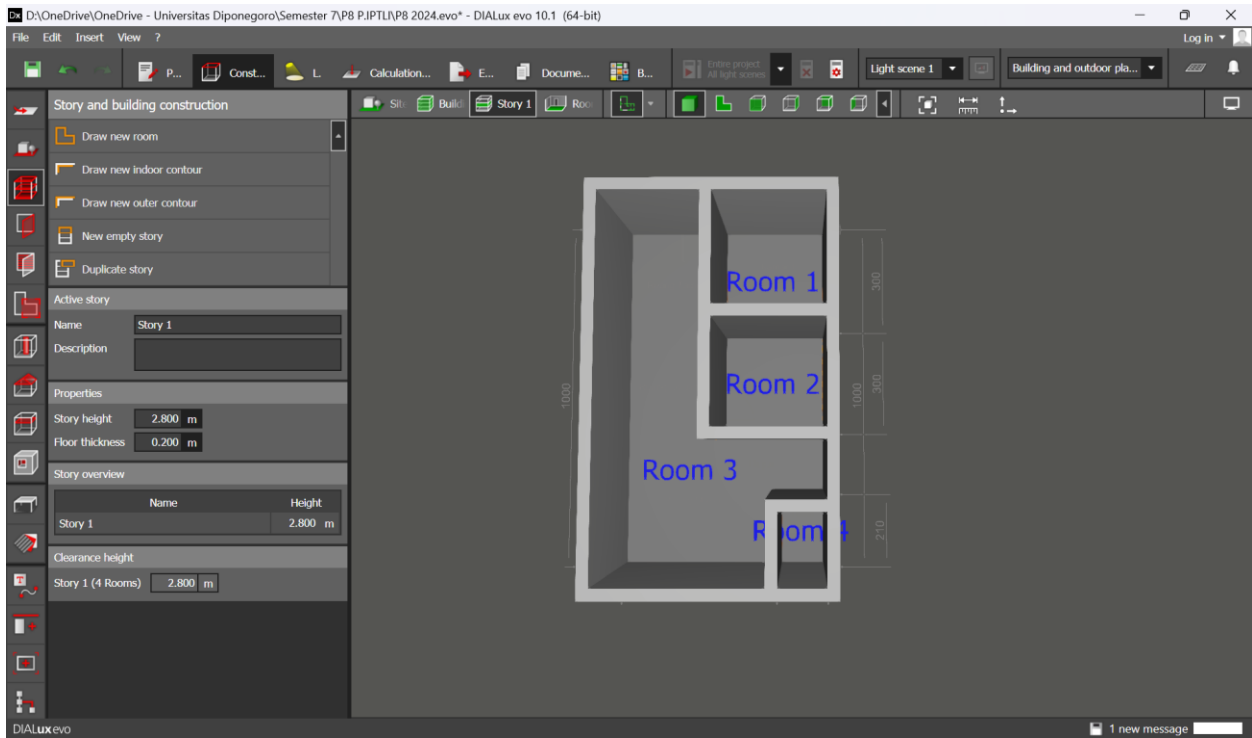

7. Furniture

Klik apertures → select → drag

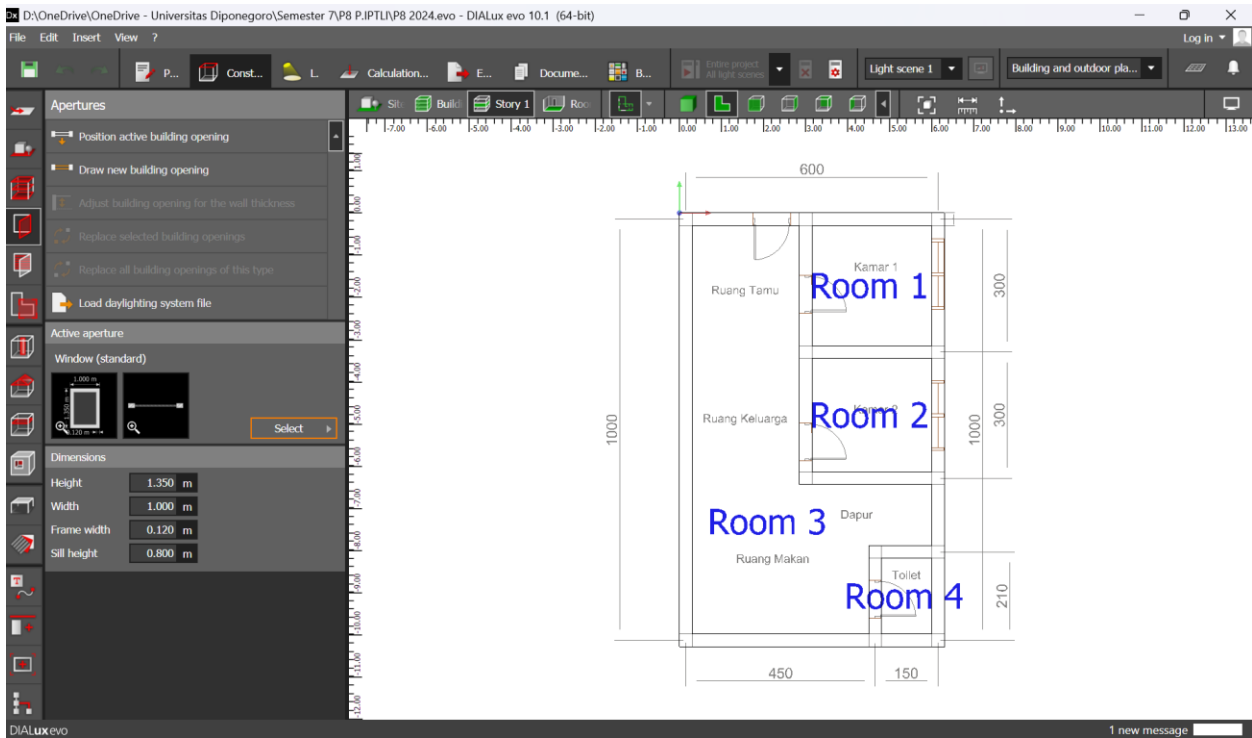

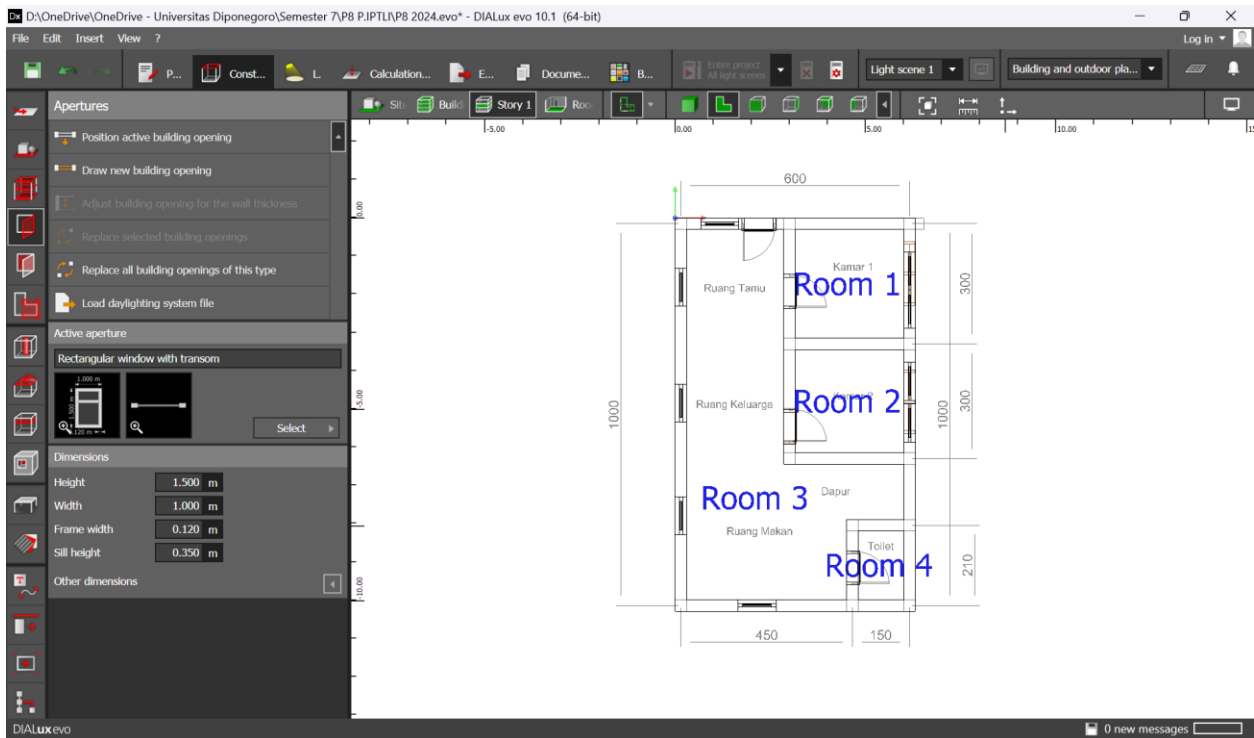
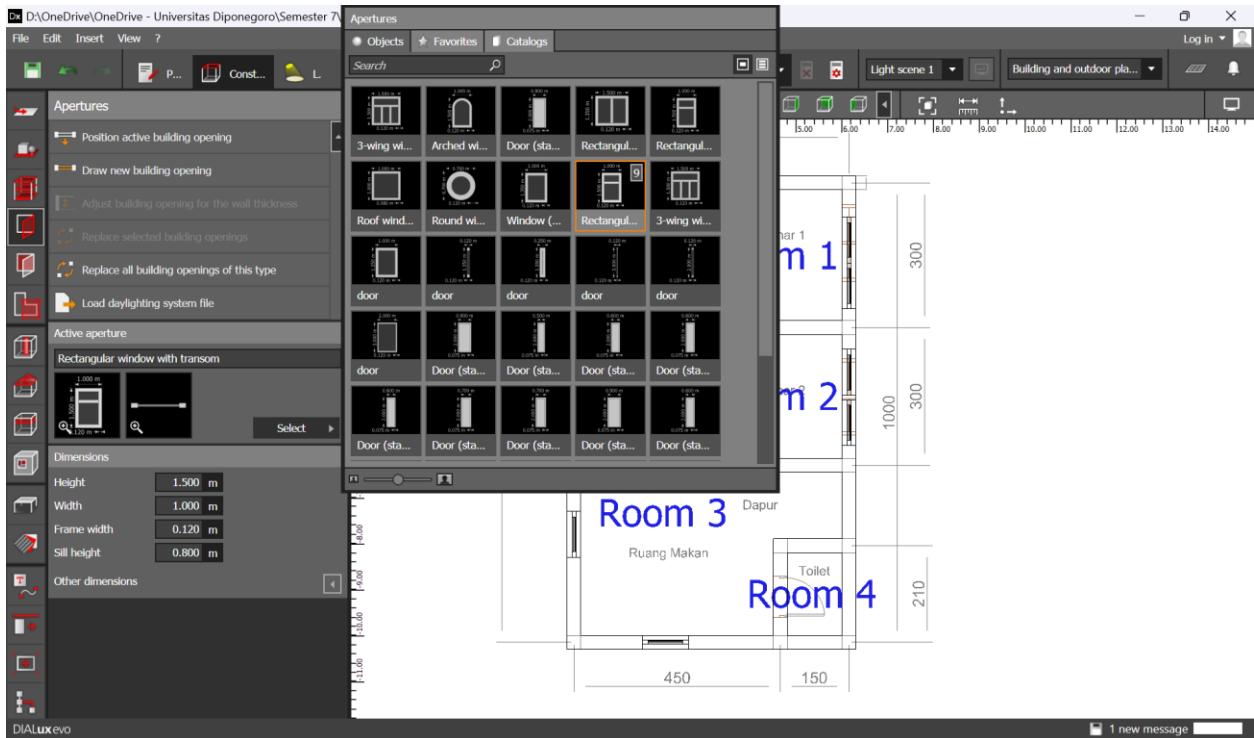

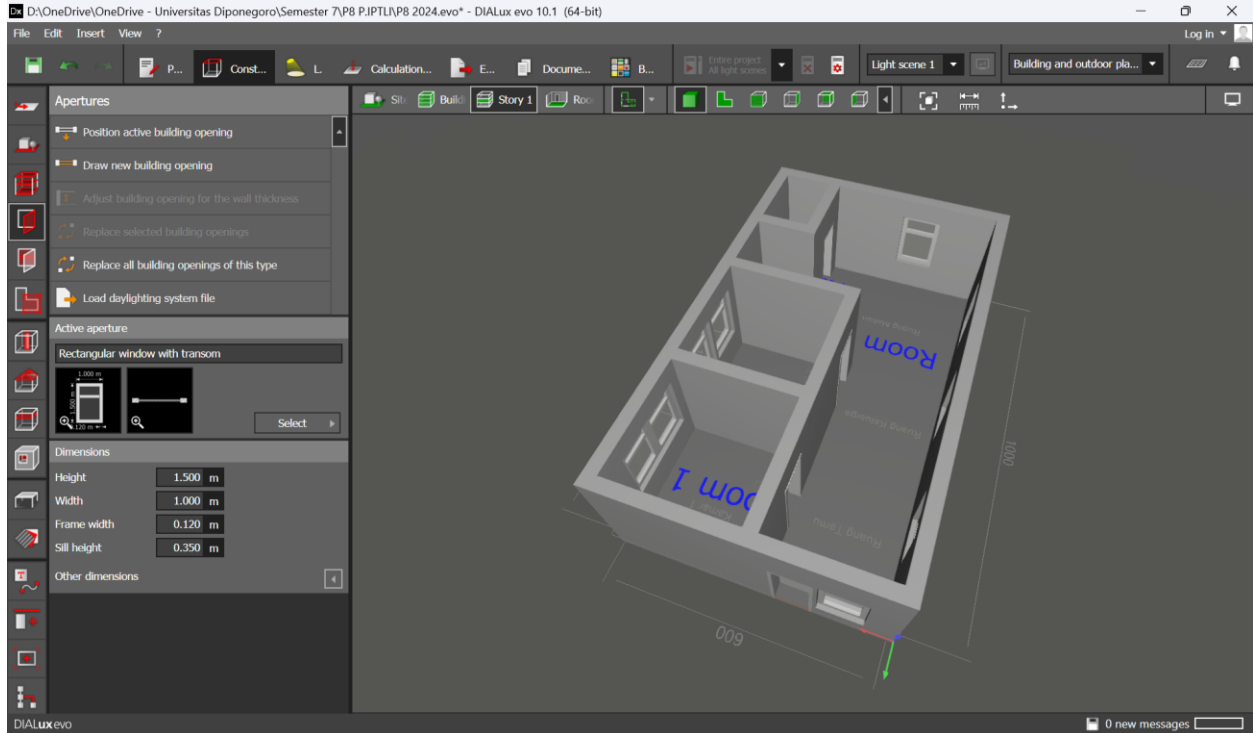

8. Space → Draw rectangular space → edit

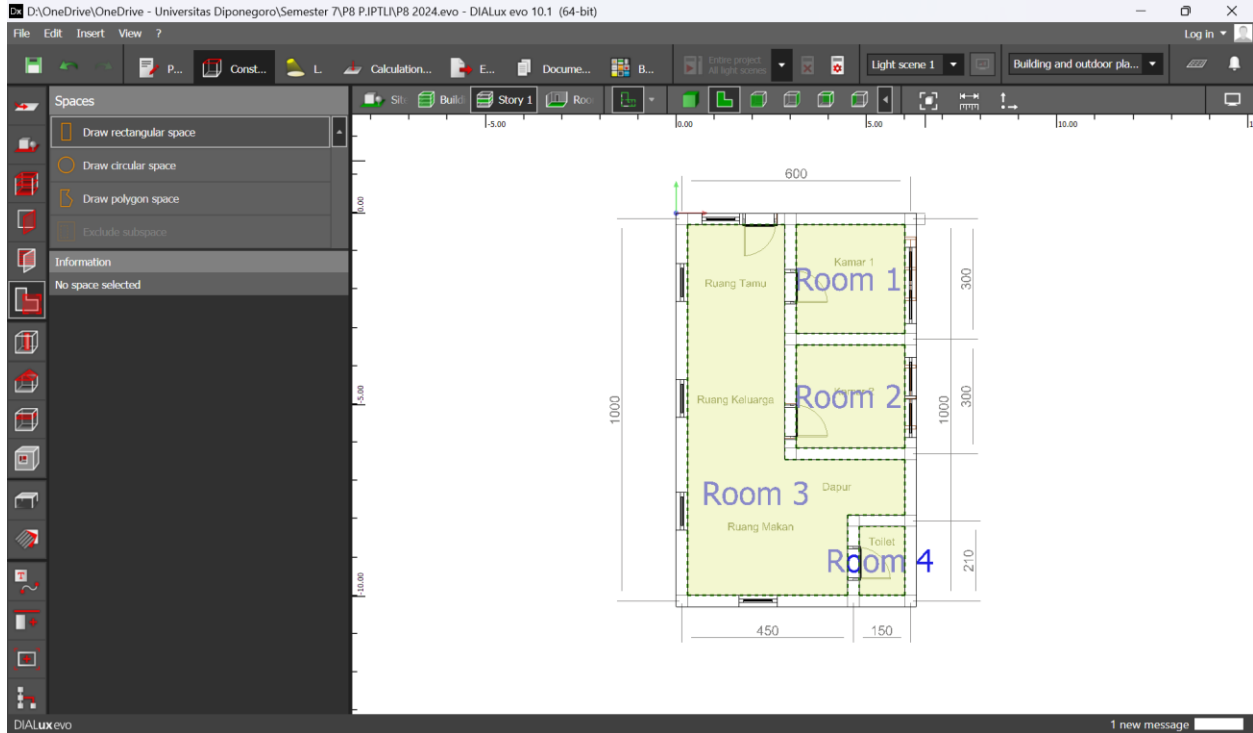

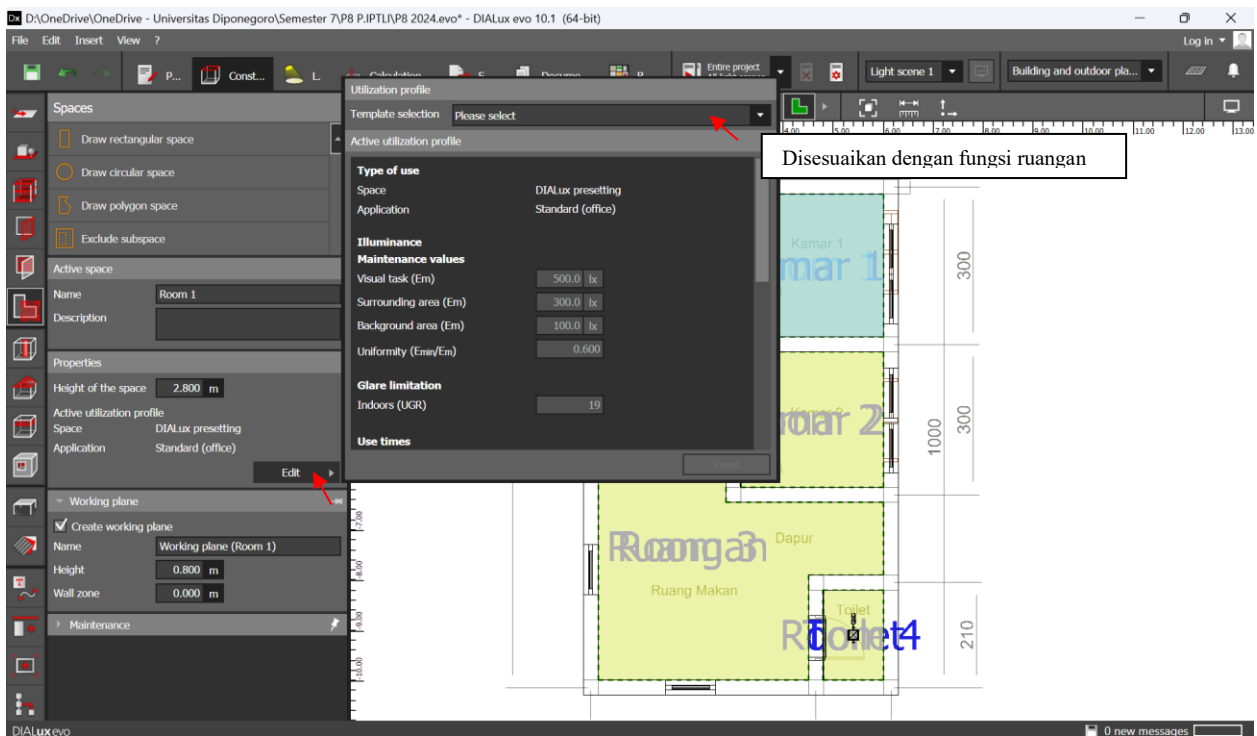
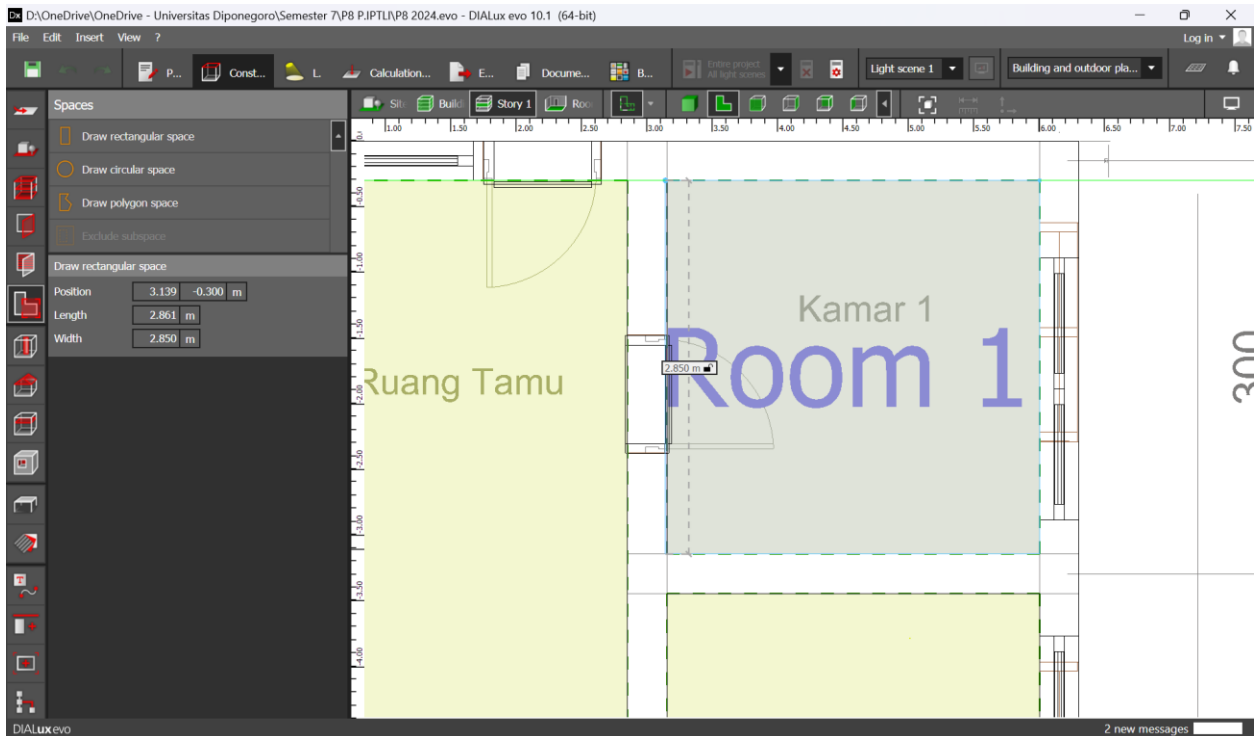

Misal untuk kamar tidur dengan lux= 50

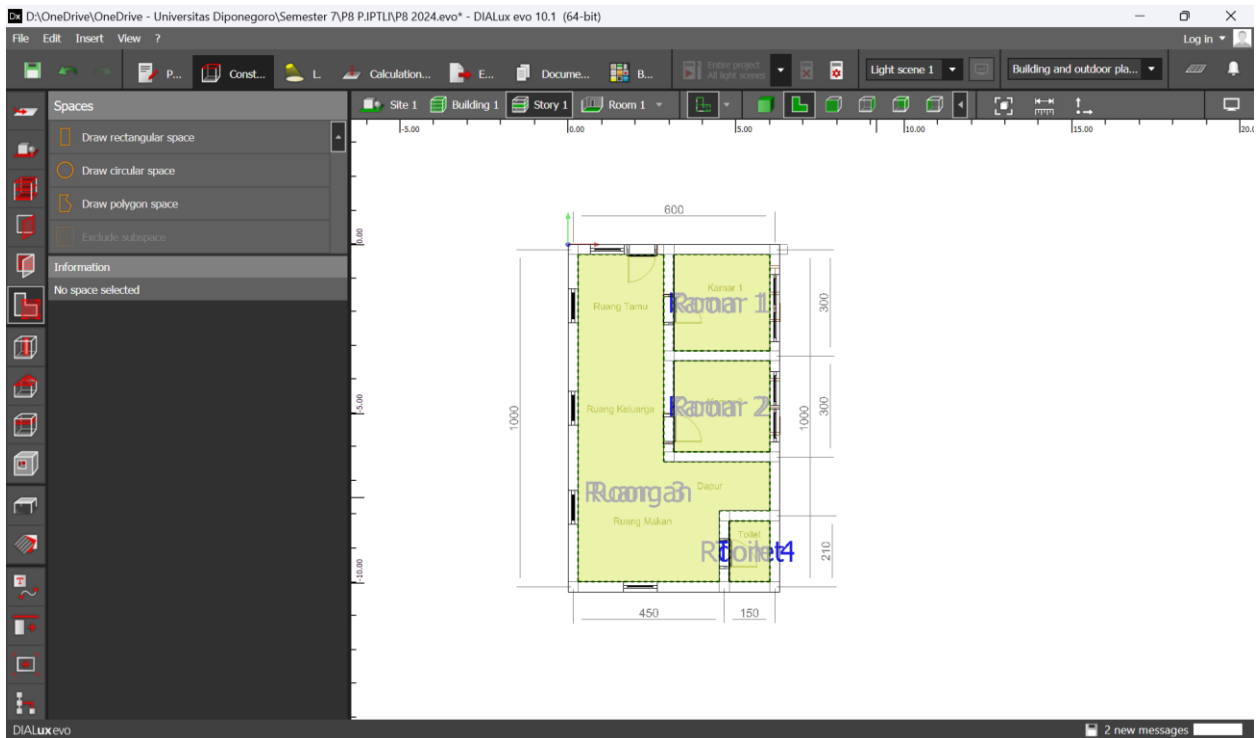
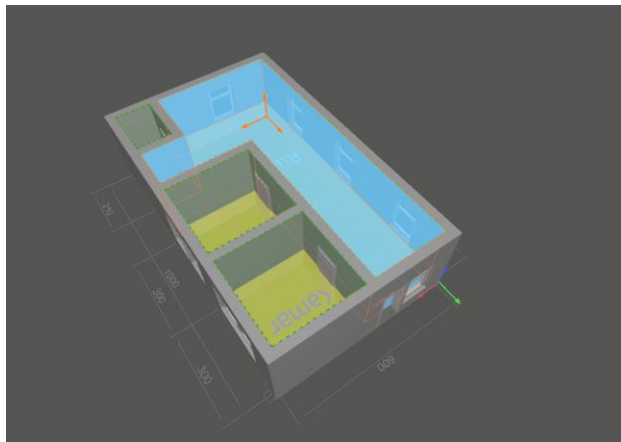
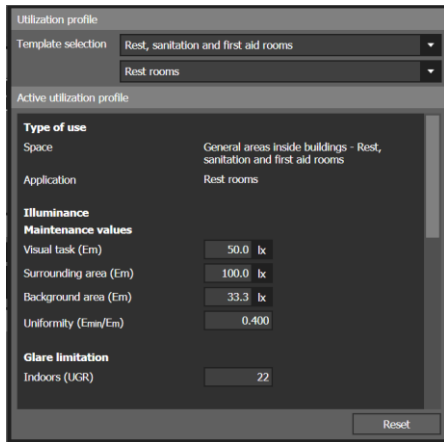

9. Atap

Ceilings → draw new ceiling (height = 3.1 m)

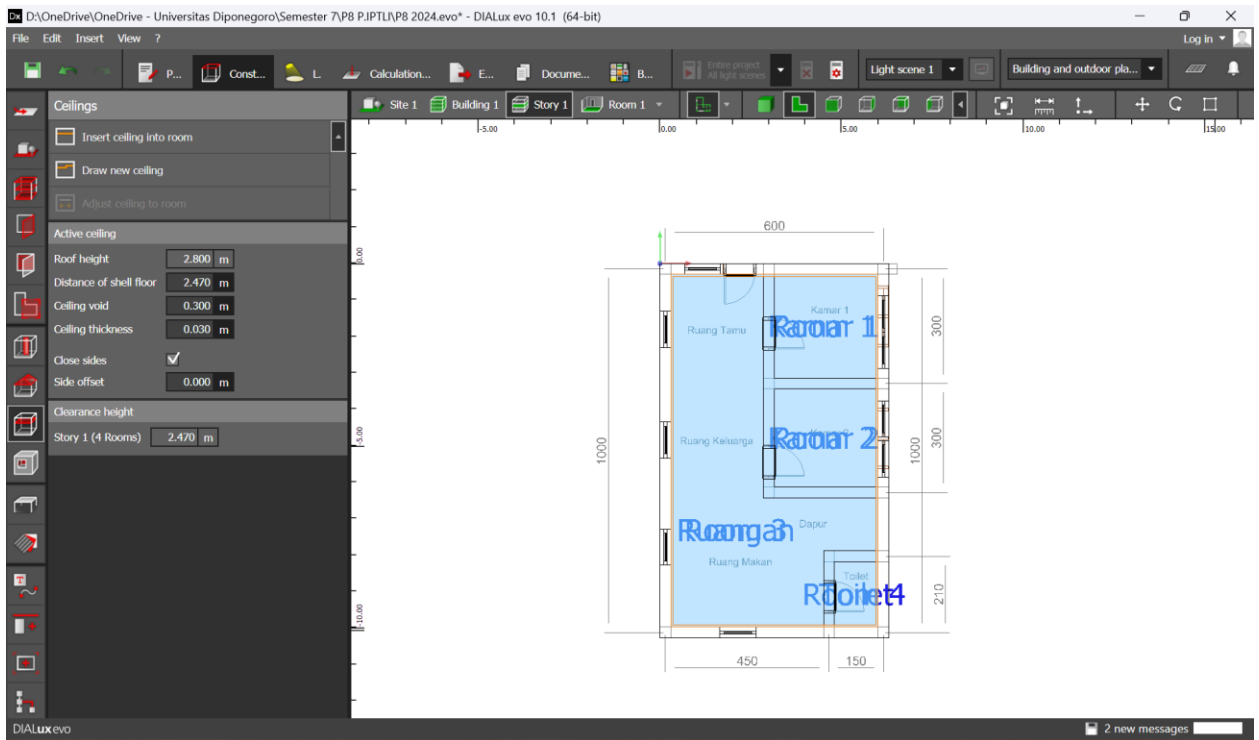
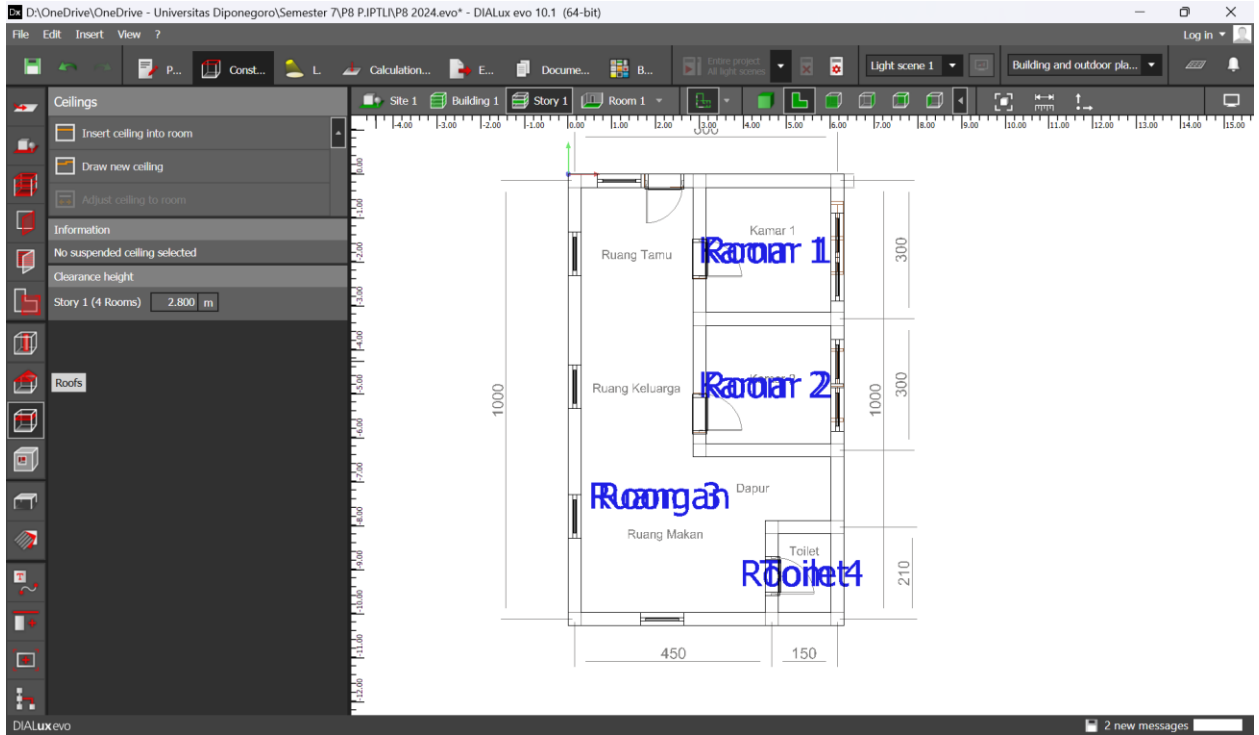

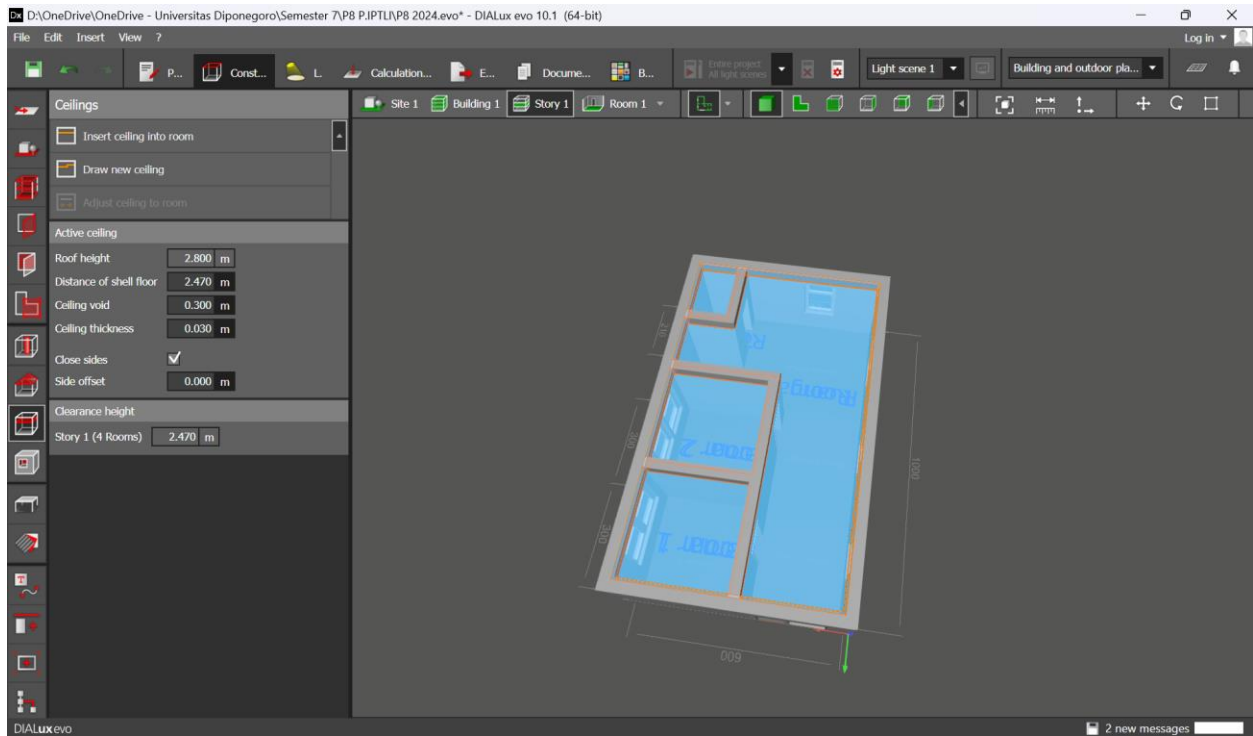

10. Iluminasi

- **Klik light → select → start product catalog → pilih lampu**
- **Pilih tergantung lumen → add**
- **Draw rectangular arrangement → pilih lampu (yang direkomendasikan)**